



COG T5 LUMINAIRE

QUICK RELEASE MOUNTING KIT INSTALLATION

DATE	October 2005	CODE	DS-C10-EU	A
PROJECT		TYPE		

1. COMPONENTS OF KIT

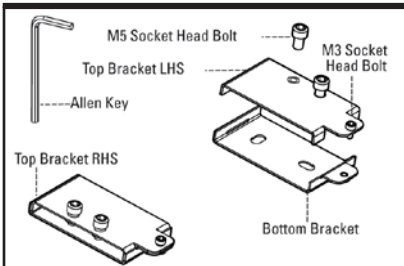

Each Quick Release Kit contains:
 1 x LHS Top Bracket, 1 x RHS Top Bracket
 2 x Bottom Brackets, 4 x M5 Socket Head Bolts
 2 x M3 Socket Head Bolts, 1 x Allen Key

2. QUICK RELEASE POSITIONING

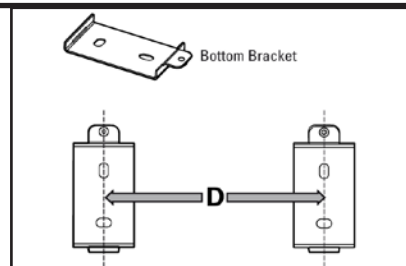

LUMINAIRE	DISTANCE (D)
14 W/24W	590mm
21 W/39W	890mm
28 W/54W	1190mm
35 W/80W	1490mm

Fasten the base brackets into position according to the specified distance, from centre to centre, as outlined in the table. Fine adjustment can be achieved on the oval shaped fixing slot if needed.

3. BOTTOM BRACKET ORIENTATION

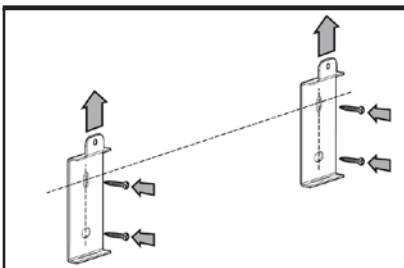

When mounting fixture in horizontal orientation on a vertical surface, ensure the brackets are positioned as shown above

4. FIXING LUMINAIRE TO BRACKETS

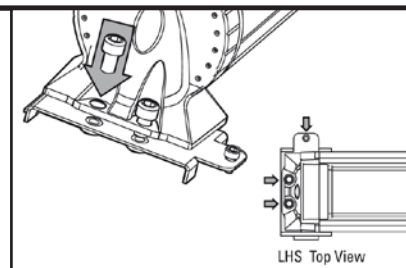

Ensure the top brackets are in the correct orientation and then use the M5 socket head bolts to fix the End Cap of the luminaire to the top brackets.

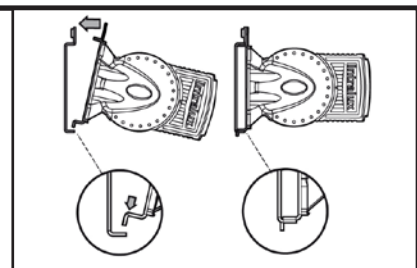

Insert the tongue of the top bracket into the slot located at the base of the bottom bracket. **TIP: Loosening both M5 socket head bolts by half a turn will assist in alignment.**

4. TIP FOR BRACKET ASSEMBLY

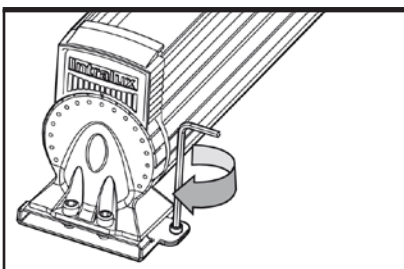

Secure the top bracket to the base bracket by using the Allen key to tighten the M3 socket head bolt.

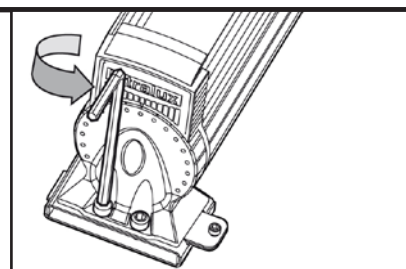

Tighten both M5 socket head bolts on the endcap, and ensure all other bolts are secured tightly.

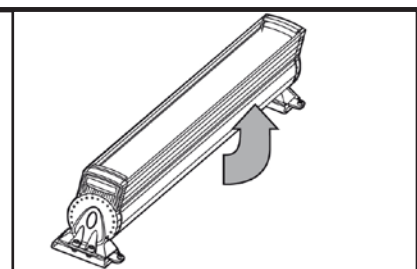

Focus the COG T5 beam to the desired location.



Intralux Australia Pty Limited 23 Enterprise Street, PO Box 557, Richlands, Brisbane, Queensland, 4077, Australia
 Tel: +61 7 3375 9333 Fax: +61 7 3375 9444 Email: info@intralux.com Web: www.intralux.com

Design and Trade Mark registrations pending. Intralux Products are designed and built to comply with appropriate International Standards. All brand names on this brochure are Trade Marks of their respective holders. Some of the images in this brochure are computer generated representations. Intralux Australia reserves the right to alter the designs and specifications of these products without notice. DS-C10-EU October 2005 E&OE

