

VERSATILE VL9050 RECESSED

VL9050 RECESSED INSTALLATION - BRACKET METHOD

Intralux

DATE	October 2023	CODE	VL9050R-IS-1	B
------	--------------	------	--------------	---

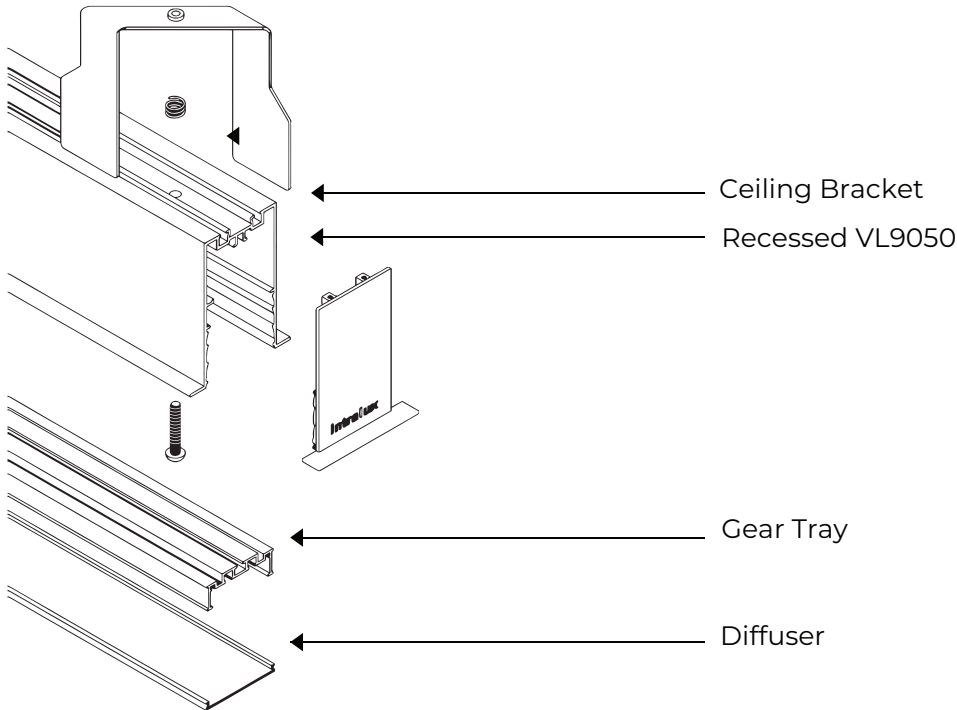

SUPPLIED PARTS

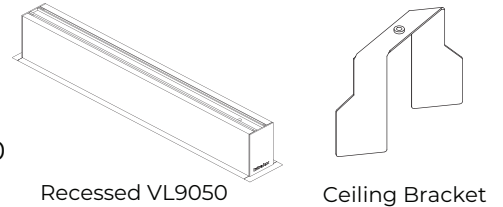

REQUIRED FOR INSTALLATION

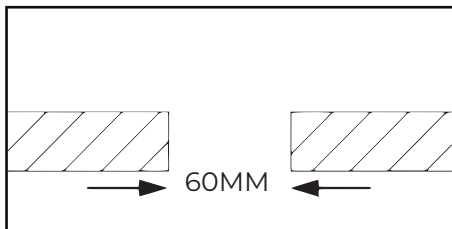

1. Slot length = Finished fixture length (including flanges) minus 18mm.

Cut a 60 mm slot in the Ceiling Material for the Trim Kit.

Trim Kit Bracket and mount designed to suit Ceiling Material thickness 5mm to 26mm.

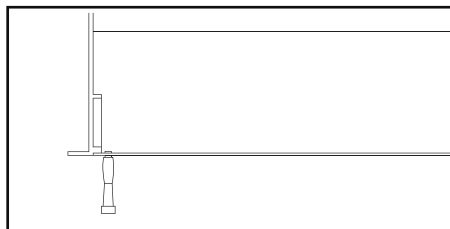

2. Remove the diffuser from your fittings.

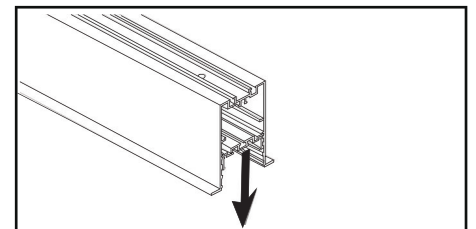

3. Remove Gear Tray from your fitting and by undoing the Phillips head screws, let it hang on the lanyards. If it is a multi fitting run, you may want to join them together with the red connectors at this point.

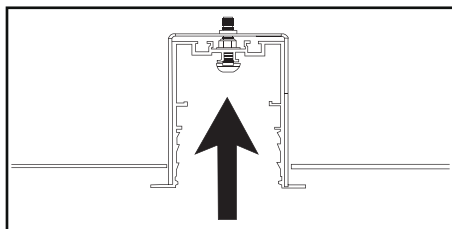

4. Rotate all the brackets so they are parallel with the slot in ceiling.

Push the fitting through the cut hole in the ceiling.

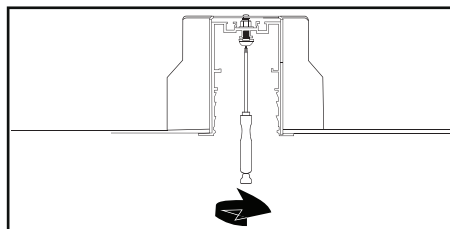

5. Tighten until fitting is drawn flush to the ceiling and firmly secured in the ceiling. **DO NOT OVERTIGHTEN** or the gear tray will be hard to install/remove.

Make electrical connections to mains power at this time.

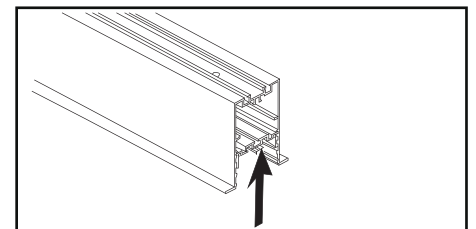

6. Replace the Gear Tray by reattaching and tightening the Phillips head screws.

Ensure Gear Tray is centered on a 'Standalone' Fitting, or that the gear trays butt-up to each other on 'Continuous / Multi-fitting' Runs. Reattach diffuser. Installation Complete.

VL9050 RECESSED MOUNTING CLIP POSITIONING GUIDE:

- Swing Bracket positioning along the luminaire is calculated by using the luminaire length (FFL) as 'X' then divide by 2 or 3 depending on length.
- Bracket quantity depends on luminaire length.
- The bracket on either end of the fitting will always be positioned 100mm from the inner profile wall.
- Luminaires will come pre-drilled to these measurements - however if there is an obstruction in the ceiling, these measurements can be modified ~100mm either direction.
- New holes through centerline of profile will need to be drilled if brackets need to be moved.
- CAUTION: Some internal components such as LED Drivers may limit where Swing Brackets can be re-installed.

Luminaire Length/FFL upto 1160mm

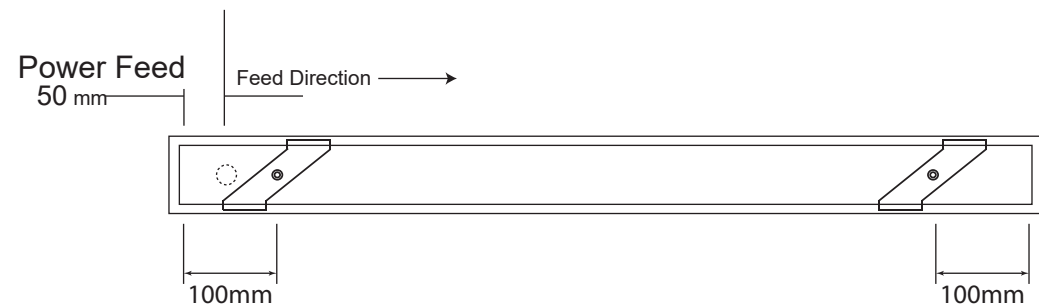

Luminaire Length/FFL between 1200mm and 2160mm

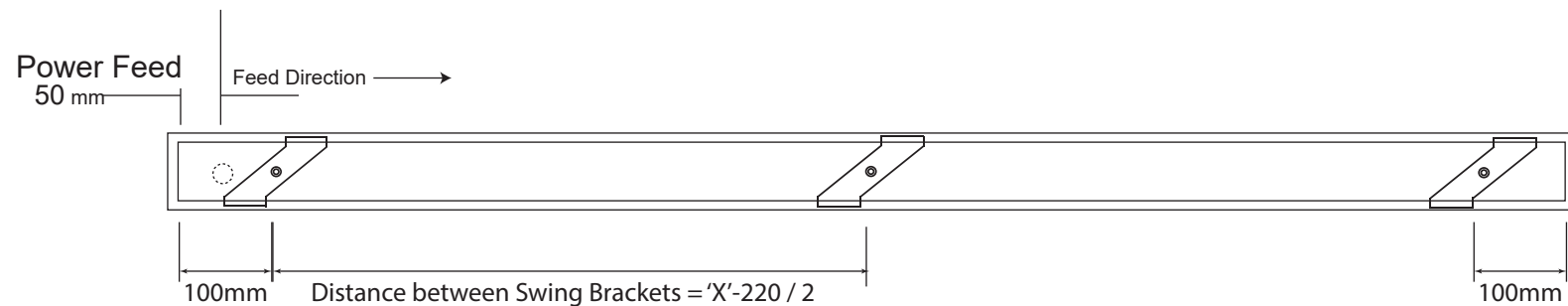

Luminaire Length/FFL over 2160mm

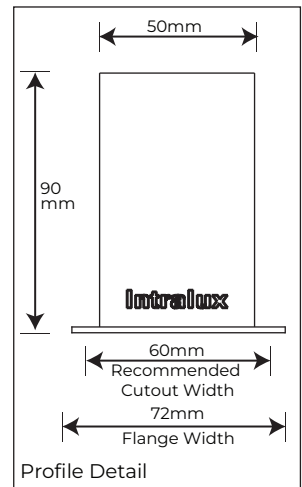
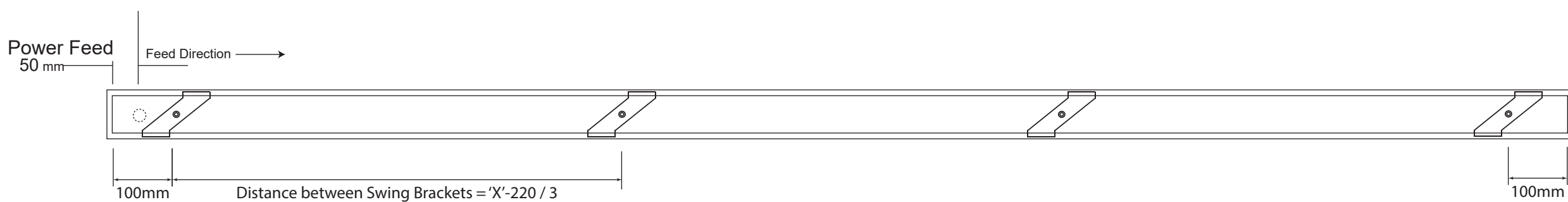

			ST	
			Drawn	



Unless otherwise stated, all dimensions to be in millimetres and toleranced as below.
 0 = +/- 1mm
 0.0 = +/- 0.5mm
 0.00 = +/- 0.10mm

Copyright © 2024 of this drawing is the property of:
 Intralux Australia
 23 Enterprise St, Richlands, QLD 4077 Australia
 Tel: +617 3726 9564

Project:	Drawn ST
Order No.	Size A3
Drawing No.	Scale DO NOT SCALE
Client Drawing Reference:	Sheet 20